

Exterior Elevation Notes

APPLICABLE CODES: 2007 CBC, CPC, CMC, CEC, CEBC, & CFC /
BASED ON: 2006 IBC, UPC, UMC, IEBC, IFC and 2005 NEC

1.0 Roofing Materials

Pitched Roofs: All pitched roofs shall be covered with fire-retardant cedar shakes over one layer non-perforated type 30# felt, lapped 2-inches horizontally and 4-inches vertically over OSB (or directly over SIP) sheathing. New roof valley flashing to be no. 28 galvanized sheet gage.
Flat Roofs: All flat roofs shall be covered with Duro-Last® Fire-retardant Roof Covering System single-ply roof covering membrane (see ES Report #ESR-1660) and installed by a manufacturer-approved contractor. Contractor shall be responsible for preparing the substrate surface in accordance with the manufacturer's installation instructions.

2.0 Exterior Wood Siding

Siding: Matching Plank-Tex® wood siding at addition over one layer non-perforated House Wrap® by Tyvek® over shear ply. All siding shall be securely fastened to each stud with not less than one nail per course not more than 24 inches on center. Fasteners shall be nails or screws with a penetration of not less than 1-1/2 inches into studs. All joints and edges of siding shall be over framing members, and shall be made resistant to weather penetration with battens, horizontal overlaps or shiplaps.

3.0 Fascia and Trim

All fascia boards and wood trim shall be 2x Socomi-Lam® engineered LVL solid wood or equal covered with Fin-Ply® plywood. Color selection by Owner. All lengths shall be continuous if material permits. All joints to be mitered, backprimed, and calked. Verify material and color selections with Owner prior to application.

4.0 Door and Window Trim

All door and window trim shall be 1x Socomi-Lam® engineered LVL solid wood or equal. Installation per manufacturer's installation instructions. All lengths to be continuous if possible.

5.0 Skylights and Vent Pipes

Non-opening skylights with aluminum anodized non-reflective frame by Sun Optics® (Warnock Hersey report #WHI-495-SP-0509) mounted on a 6-inch curb.
All vent pipes shall terminate not less than 10 feet from, or at least 3 feet above, any operable window, door, opening (operable skylight), air intake or vent shaft.

7.0 Clearance and Drainage

Wood used in construction of permanent structures nearer than 6 inches to earth shall be treated wood or wood of natural resistance to decay. When wood joists are located closer than 18 inches or wood girders are located closer than 12 inches to exposed ground in crawl spaces, they shall be approved wood of natural resistance to decay or treated wood. Surface rainwater shall be drained away from the foundations 1/4-inch per foot a distance of 5 feet.

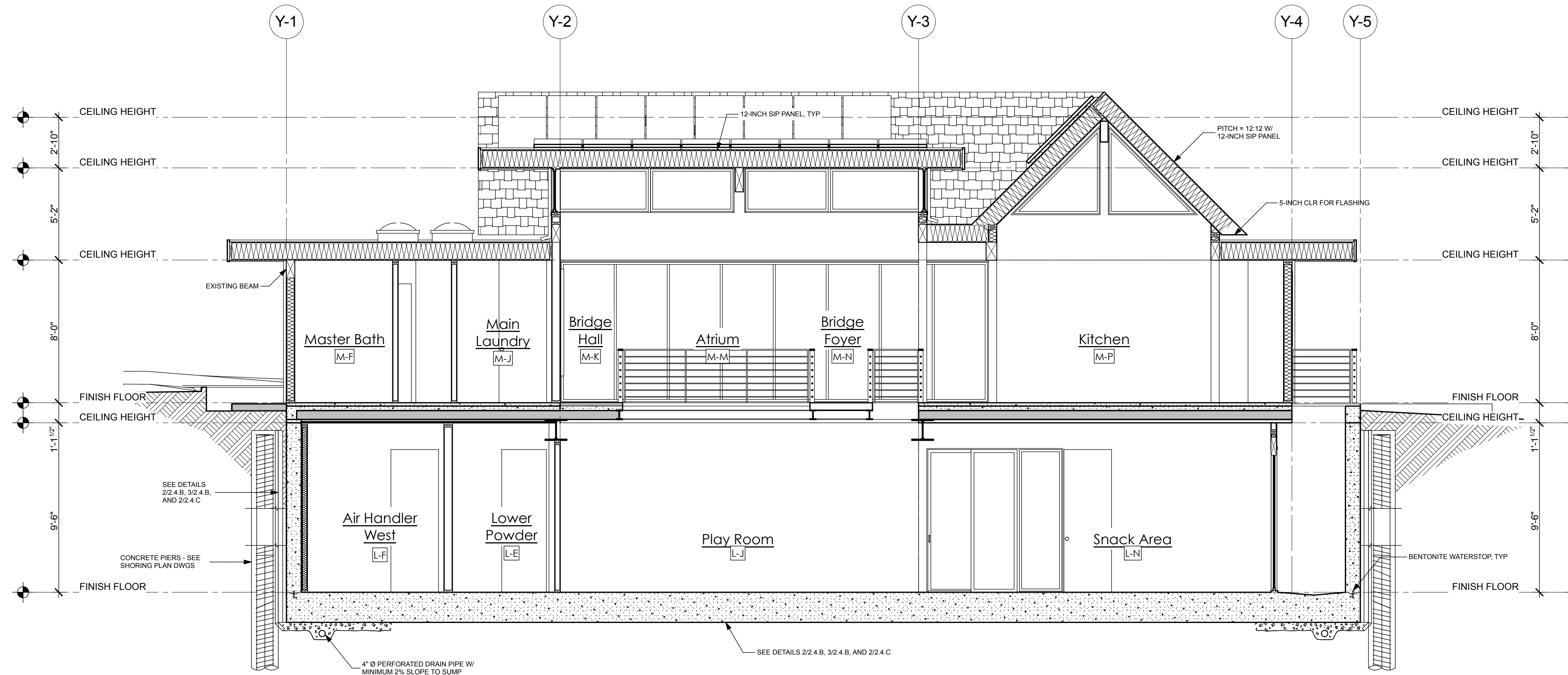

1 Cross Section X-3.3
Scale: 1/4" = 1'-0"

THIS WORK WAS PREPARED BY
JOHN A. RIDER, ASSOCIATE AIA
OR UNDER MY SUPERVISION.

Signature

Jrider + Design
73 PLEASANT RIDGE AVENUE
SAN JOSE, CALIFORNIA 95127
408-259-1515 phone/fax

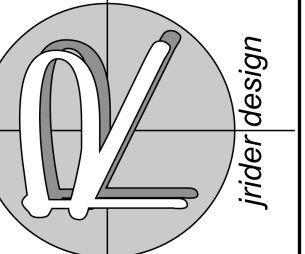

MEKECHUK/SINCLAIR RESIDENCE
REMODEL AND NEW BASEMENT
17509 VIA SERENO
MONTE SERENO, CA 95030

Rev	Description

Date: 11/29/08
Scale: AS NOTED
Drawn By: JR
Checked By: John A. Rider
Job: 11-08
Sheet Number:

4.1